

# NAKNAK

1/2

## SHELF

### Designer

Yun Li

### Material

Steel, Glass

### Finishing

Powder Coating

### Texture

Fine Sand

### Loading

3 kgs



**SHELF is a mirror with a shelf. People incidentally glance in the mirror as they leave home, and SHELF reminds them to bring necessary items. Personal accessories, such as keys, sunglasses, and wallet can be stored on the shelf. The object provides a simple yet functional solution for your entrance.**

設計理念靈感來自於人們不自覺地想要在出門前想照一下鏡子，檢視自己儀容的反應。SHELF玄關鏡鏡框局部延伸出的平面空間可放置鑰匙、太陽眼鏡等物品，壁掛於玄關處，整理儀容的同時也提醒使用者不要忘記隨身攜帶的物品。

# NAKNAK

2/2

## SHELF

### Designer

Yun Li

### Material

Steel, Glass

### Finishing

Powder Coating

### Texture

Fine Sand

### Loading

3 kgs

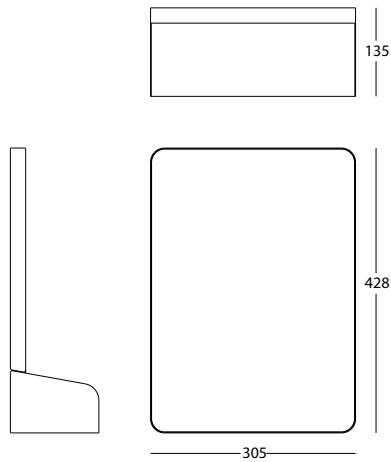

White



Black

### Contents

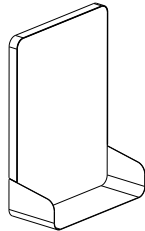

+

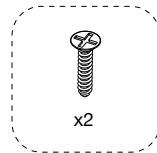

+

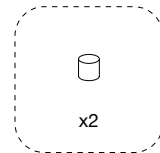

### Assembly

#### Step1

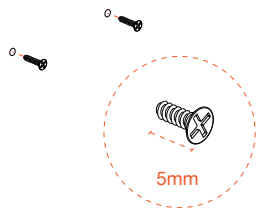

Locate 2 screws at desire height for the shelf mirror.  
(Recommend leaving 5mm of the screw from the wall.)

#### Step2

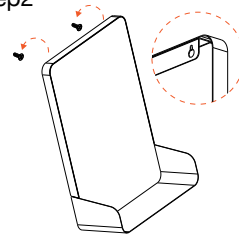

Hang on the mirror by aiming the two holes to the two crews. Lock in the screws with pull down motion.

#### Step3

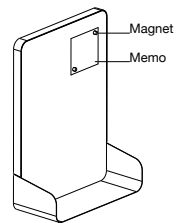

Complete.